

1644 ABBOT KINNEY BLVD

VENICE, CA 90291

FOR LEASE



Brandon Cohan | brandon@bcre.la | 310 654 0200

BC BRANDON COHAN
REAL ESTATE // BCRE.LA

1,676 SF of FLAGSHIP TROPHY RETAIL with an additional 1,013 SF patio on on LA's most walkable street - Abbot Kinney Boulevard





 lululemon

alo

 vuori
DS&D
URGALE LABO®
GRASSE - NEW YORK

VINCE.



Madewell

ABBOT KINNEY BOULEVARD

Abbot Kinney Boulevard in Venice, CA, is a premier, mile-long retail and dining strip dubbed the “**Cooldest Block in America**” by GQ. It features high-end boutiques, luxury brands, and upscale restaurants.

The area attracts affluent young professionals (with an average income of \$105,800) and tourist alike, with median home prices higher than 99% of U.S. neighborhoods and 94.7% of California neighbourhoods.

1644 ABBOT KINNEY BOULEVARD

1,676 SF AVAILABLE



**BRAND NEW Elwood Clothing
coming in next door**

Prominent Signage Opportunity

**Large glass storefronts
allowing for window displays**

**Large walkway and patio
surrounding building**

1644 ABBOT KINNEY BOULEVARD - FLOOR PLAN

1,676 SF AVAILABLE

+ 1,013 SF COURTYARD AREA

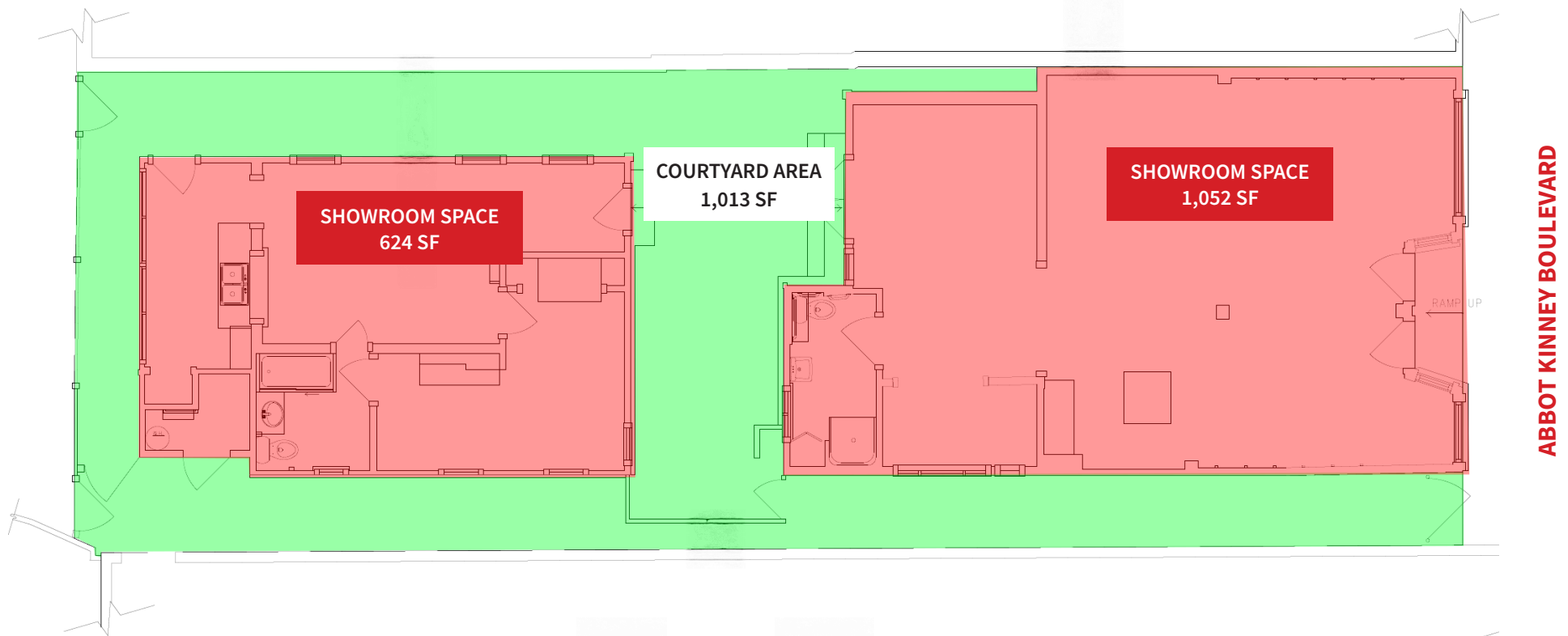

RETAIL SPACE

1,676 SF AVAILABLE



Drop ceiling can be raised higher

Large glass windows allowing for plenty of natural light



Built-in skylights

Open floor plan ideal for showcasing product

COURTYARD + WRAP AROUND PATIO

1,676 SF AVAILABLE

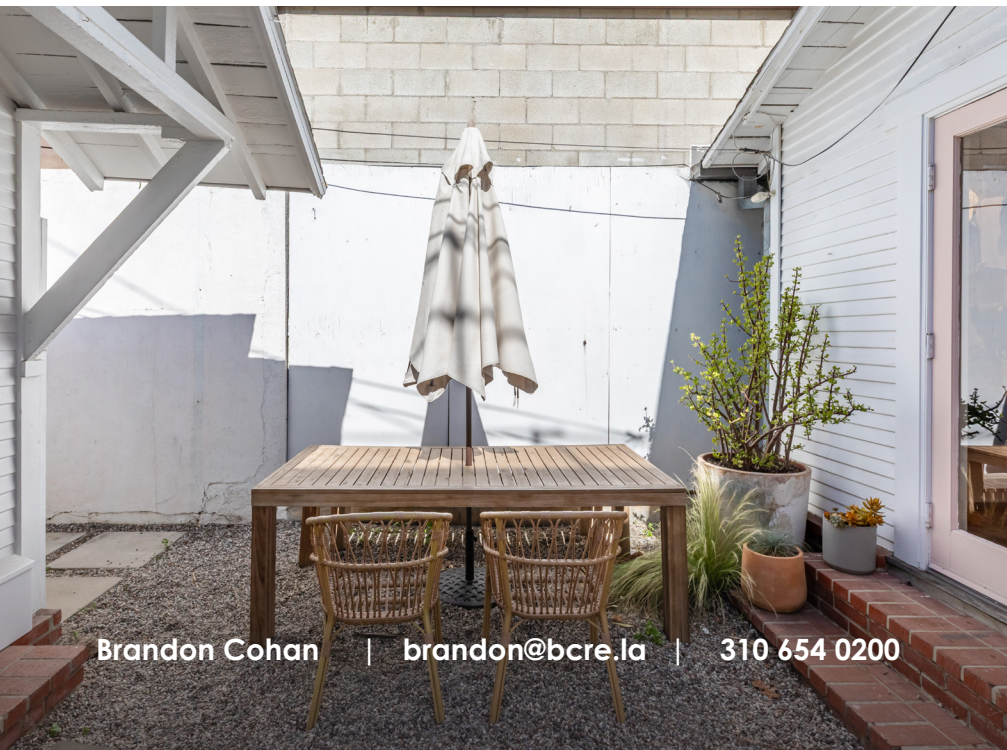





BRANDS ON ABBOT KINNEY BOULEVARD

VEJA



AVIATOR NATION



DS&DURGA



BIRKENSTOCK



ALO YOGA



VUORI



ON RUNNING



MADEWELL



LULULEMON



FRANKIES BIKINIS



LEVAIN BAKERY



BUCK MASON



Brandon Cohan | brandon@bcre.la | 310 654 0200

BC BRANDON COHAN
REAL ESTATE // BCRE.LA

1644 ABBOT KINNEY BLVD

VENICE, CA 90291

FOR LEASE

