

351-355 N CANON DRIVE

BEVERLY HILLS, CALIFORNIA 90210

BRANDON COHAN

REAL ESTATE



BRANDON COHAN | 310.654.0200 | Brandon@bcre.la | www.BCRE.LA



PROJECT DETAILS

ADDRESS

351-355 N. Canon Drive
Beverly Hills, CA 90210

PRICE

Ground Floor: Negotiable
Second Floor: Negotiable

SIZE TOTAL: ±2,000 - 8,000 SF

Ground Floor: ±2,000 - 4,000 SF
(can be split in half)
Second Floor: ±4,000 SF

USE

Restaurant/Retail/
Hair Salon/Office

NNN

Approximately \$2 PSF/month

PARKING

14 spaces in rear
Huge outdoor patio dining potential



ENTRANCE



FRONT INTERIOR



TOWARD REAR INTERIOR



VIEWS FROM INSIDE LOOKING OUT



OPEN FLOOR PLAN

FLOOR PLANS

SIZE

±2,000 - 8,000 SF

TOTAL AVAILABLE

GROUND FLOOR

±2,000 - 4,000 SF

SECOND FLOOR

±4,000 SF

DIMENSIONS

50_w X 80_L FT

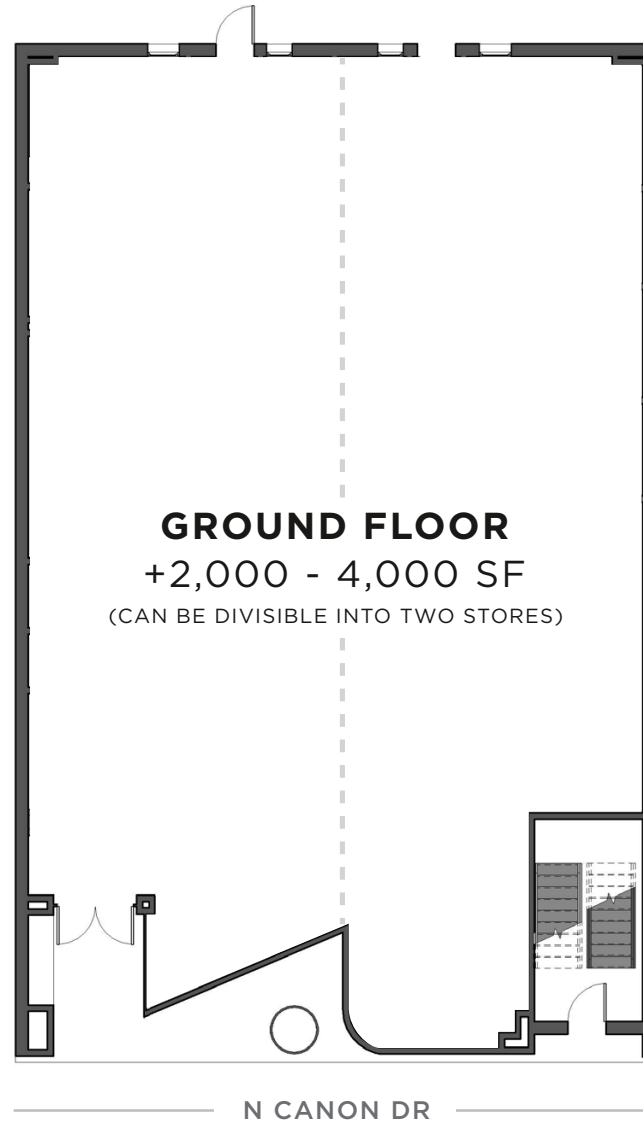



VIEWING SOUTHEAST



FRONT EXTERIOR



FRONT EXTERIOR VIEWING LEFT SIDE



VIEWING SOUTHEAST



FRONT EXTERIOR VIEWING RIGHT SIDE

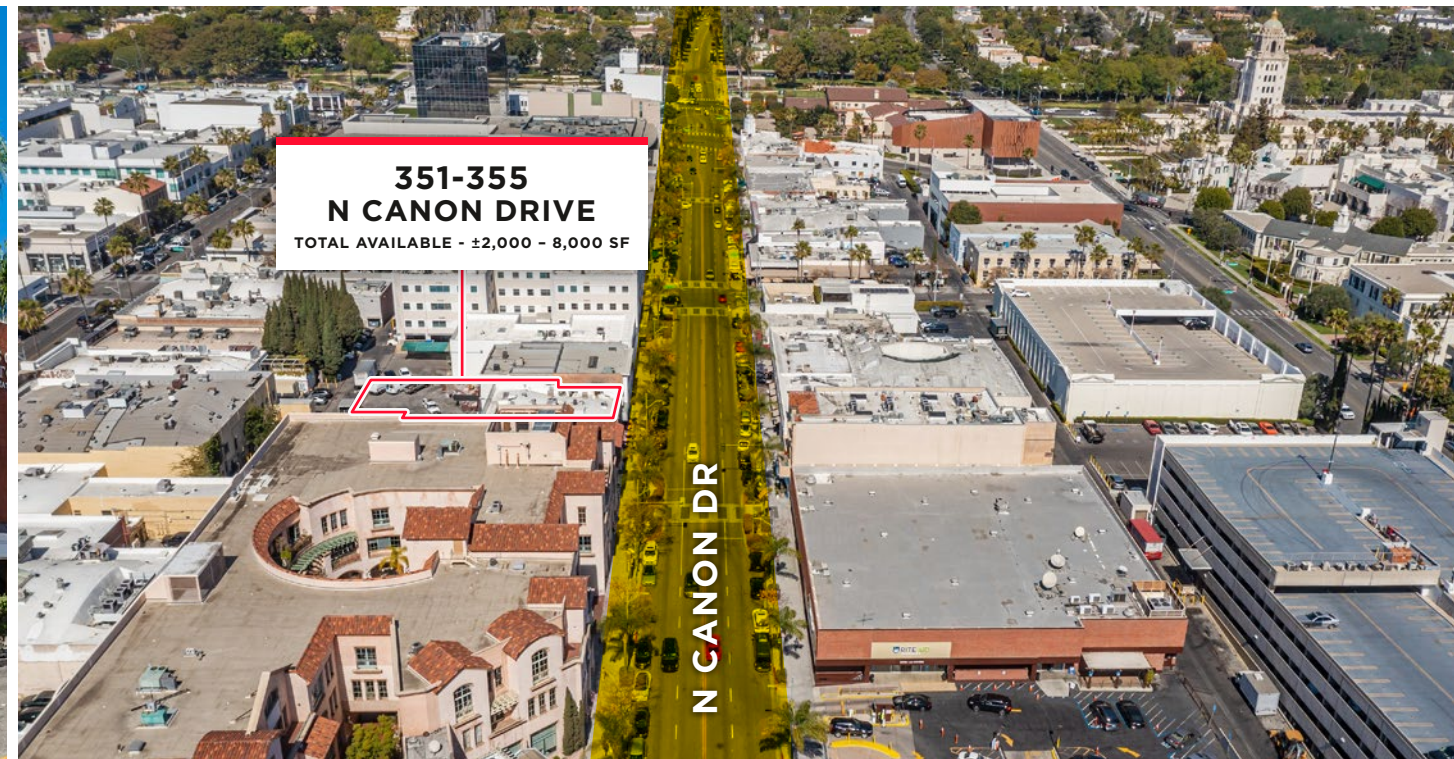

VIEWING NORTHWEST

PARKING OR OUTDOOR DINING REAR PATIO

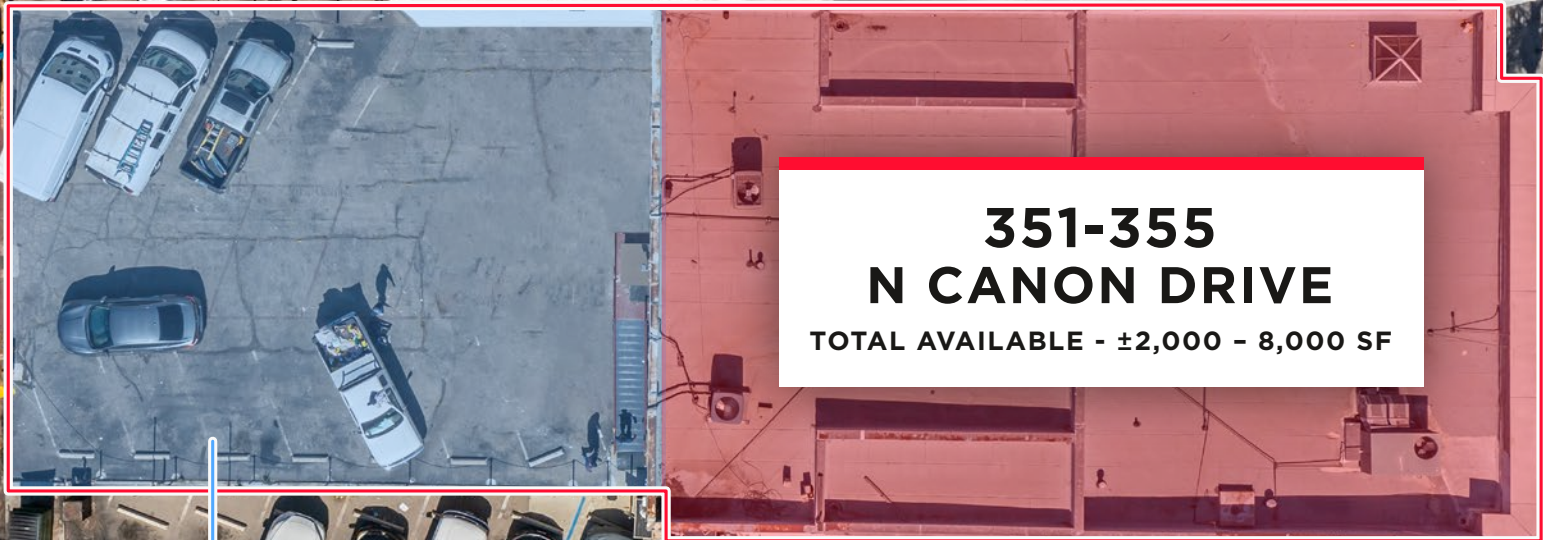

**351-355
N CANON DRIVE**
TOTAL AVAILABLE - ±2,000 - 8,000 SF

**14 PARKING
SPACES/OUTDOOR
DINING PATIO**

AREA MAP



MAYBOURNE
HOTEL GROUP

Palm
RESTAURANT

NOVIKOV

CHOTTO
MATTE

VIA
ALLORO

**351-355
N CANON DRIVE**
TOTAL AVAILABLE - ±2,000 - 8,000 SF

PUBLIC PARKING
STRUCTURE

CHANEL

LVMH

MULBERRY
PIZZERIA
STREET

JAMES PERSE

e. baldi

YOSEMITE
JAMES PERSE

CROFT
ALLEY

RODEO DR
N BEVERLY DR

SUGARFISH
BY SUSHI NOZAWA

alo

il Pastaio

MIRAME
MIRAMONTE CA

Wally's

MASTRO'S
STEAKHOUSE

Spago

BRIGHTON WAY

N CANON DR

PortaVia

LA SCALA

TATEL

351-355 N CANON DRIVE

BEVERLY HILLS, CALIFORNIA 90210

BRANDON COHAN

Founder, BCRE

310.654.0200

Brandon@bcre.la

www.BCRE.LA

LIC.#01903949



BRANDON COHAN

REAL ESTATE